



231 Highland Street, Suites C & D East Bridgewater, MA

2,000 SF Office Space FOR LEASE - \$12/SF



Marketed by:

Hartel Commercial

230 Jones Road | 40 Willard Street
Suite 6 | Suite 207
Falmouth, MA | Quincy, MA

Greg Hartel
617-256-3169

Greg@HartelRealty.com

Gretchen Halloran
508-524-9080

Gretchen@HartelRealty.com

Main Office:
508-444-0172

www.HartelRealty.com

231 Highland Street Suites C & D ~ Details

- ▶ Suite C 1st Floor
- ▶ Suite D 2nd Floor
- ▶ 2,000 SF Each
- ▶ Lease Terms \$12/SF Gross
- ▶ Ceiling 10'
- ▶ Heat is FHA by Gas
- ▶ Fully Air Conditioned in Office Areas
- ▶ 25+ On Site Parking Spaces
- ▶ Baths are Private
- ▶ Zoning is Industrial
- ▶ Street Signage



Neighborhood Overview

- ▶ The neighborhood is a mix of retail, commercial and industrial buildings. Highland Street is a two lane roadway with moderate traffic levels. It connects to Route 18 (Bedford St) east and Elm St west. The eastern and western ends of Highland St are mostly residential, while the locus near Route 18 is heavy with commercial activity.
- ▶ Located close to Routes 24 and I-495 and just north of Southeast Medical Center.
- ▶ Current tenants include Day Care Center, Ann Marvin Realty Co., Triple D Arborists, and J & J Yardcare.



SATELLITE



LAYOUT SUITE C

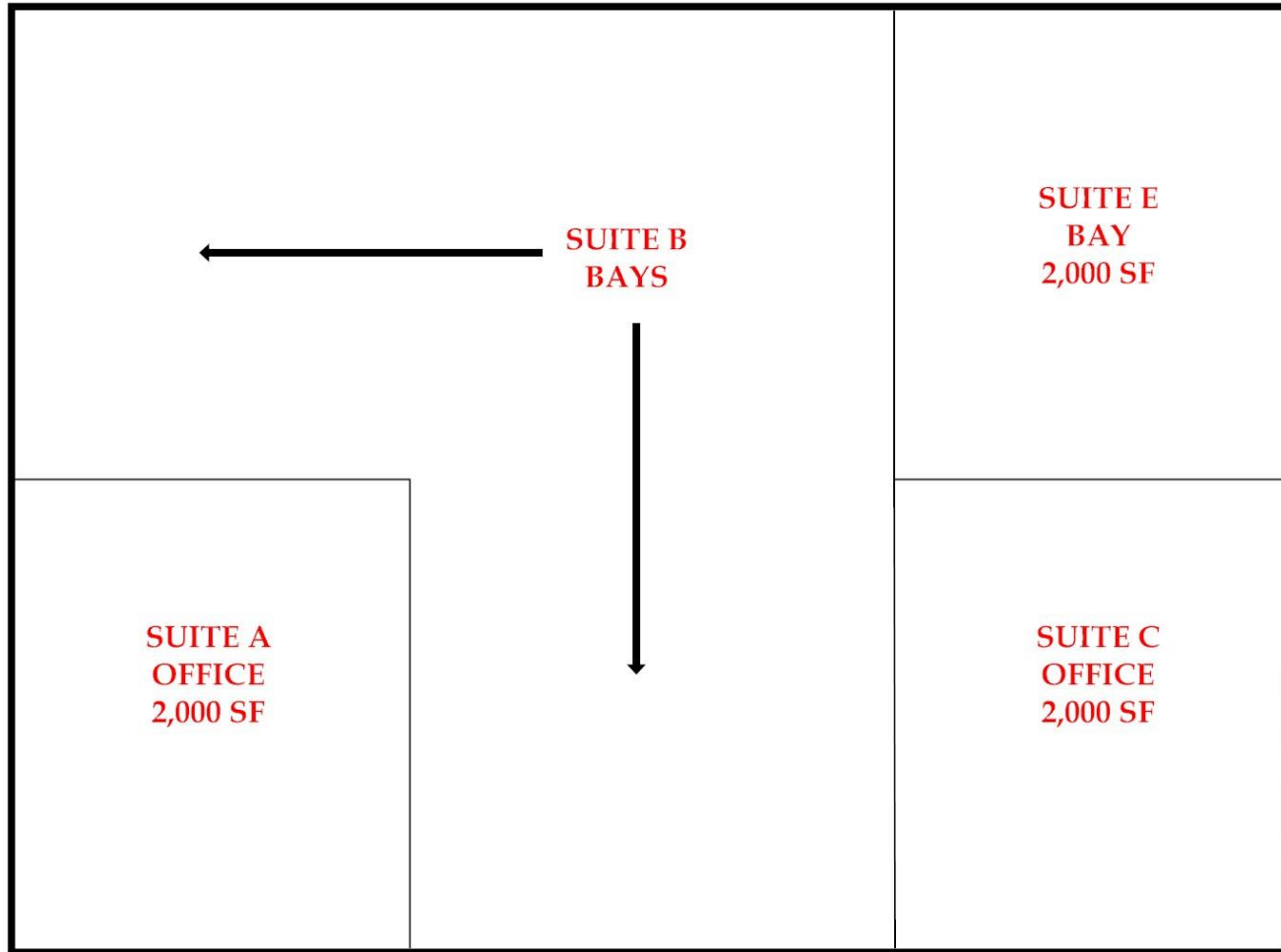

LAYOUT SUITE D

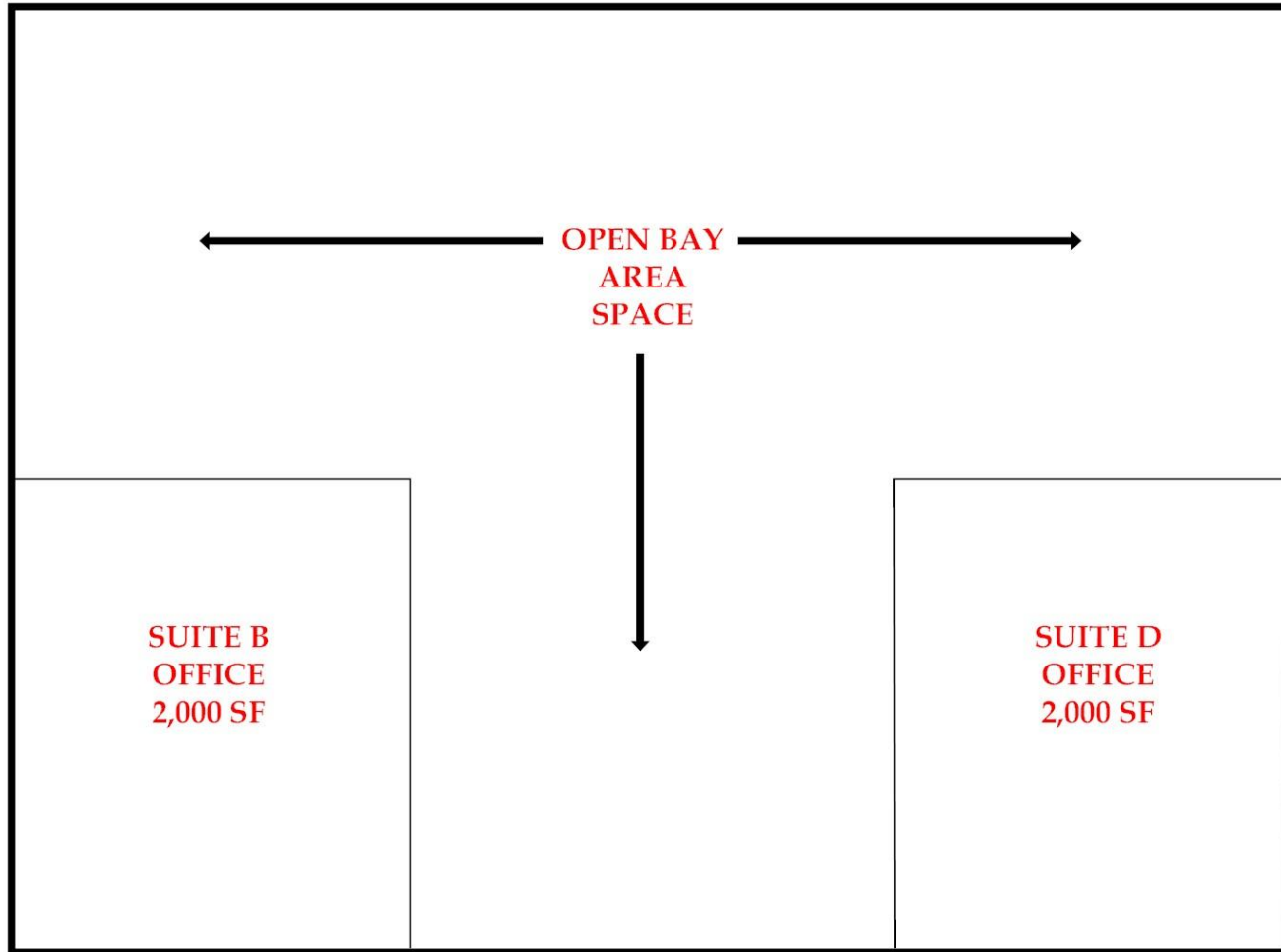

LOCATION

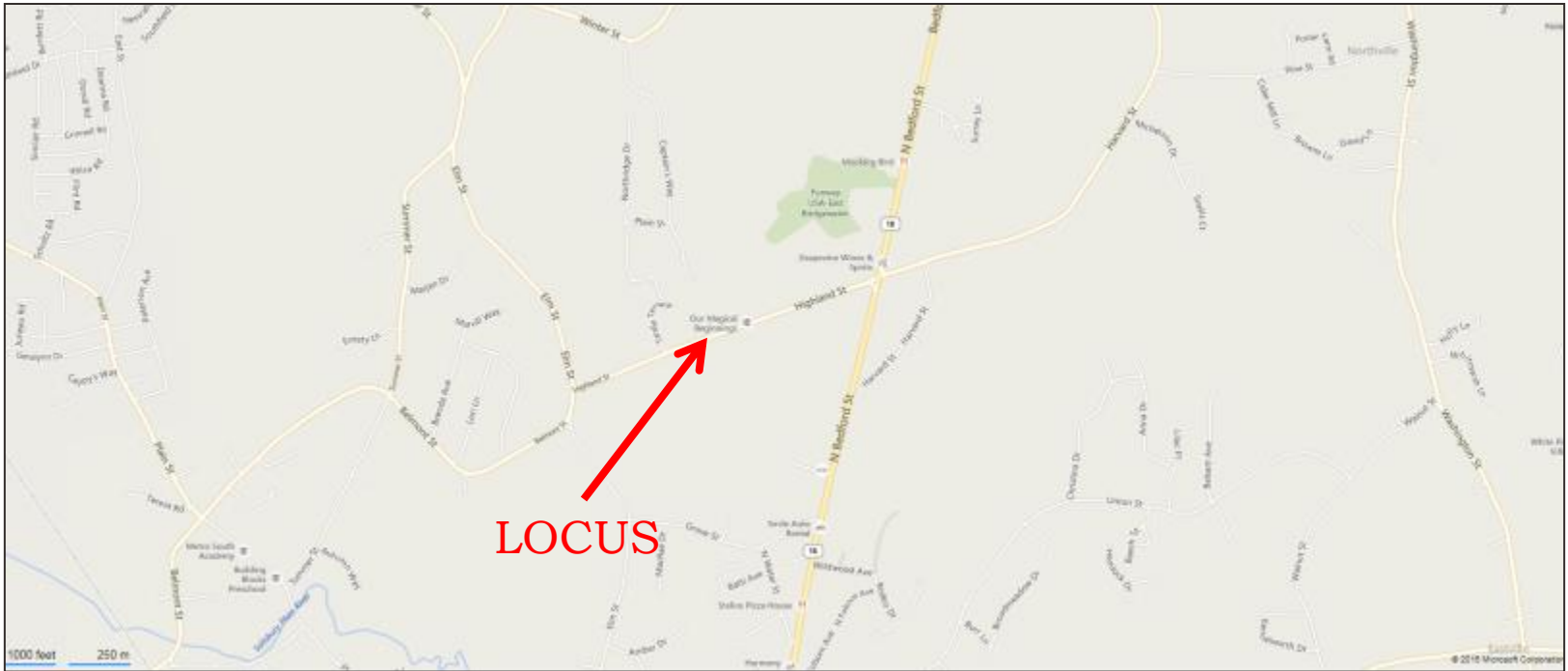

PHOTOS

