

RESIDENTIAL  
LAND AVAILABLE  
BALLYMEADE ESTATES

Marketed by:



**HARTEL REALTY**

230 Jones Rd, Ste 6—Falmouth  
40 Willard St, Ste 207—Quincy



## Lot 6 Highwood Lane ~ E. Falmouth

**OFFERED FOR SALE AT**

**\$339,000**

**FY2020 Assessment - \$226,300**

**.79 Acre Single Family Parcel**

**Exclusive Private Subdivision**

**Superior Quality Homes**

**Two Golf Courses ~ Full Service Clubhouse**

**Custom Build your Home ~ Amenities Abound**



### **Your Hartel Contacts:**

- Jody Shaw

508-566-3556

[Jody@HartelRealty.com](mailto:Jody@HartelRealty.com)

- Greg Hartel

617-256-3169

[Greg@HartelRealty.com](mailto:Greg@HartelRealty.com)

Main Office: 508-444-0172

## ***Ballymeade Estates***

**B**allymeade Estates and Country Club contains 1,000± acres of private subdivision located on Route 151, 7± miles south of the Bourne Bridge and just 1 mile from Route 28, points north and south. Route 151, the mid point to Falmouth Center, connects to Mashpee east and North Falmouth west. This private subdivision is in very close proximity to major highways, yet nestled in an area of secluded tree-lined privacy abutting conservation land.

## *Lot 6 Highwood Property Overview*



The property is located on a quiet cul-de-sac in the highly sought after Ballymeade Estates. This subdivision consists of superior, luxurious homes with gated entrance and security, many amenities and breathtaking views from certain elevations of distance water views. There is a semi-private golf course which welcomes the public and a private golf course for members only, each with its own State of the Art Clubhouse.

Amenities include Swimming Pool, Health Club, Restaurants and Common Areas.

## *Lot 6 Highwood Property Details*

<b>Property Use:</b>	Residential Single Family Parcel
<b>Sale Price:</b>	<b>\$339,000</b>
<b>2020 Assessment:</b>	\$226,300
<b>Land Area:</b>	.79 Acre
<b>Association Fees:</b>	\$1,350/Annual—Common Areas, Road Maintenance, Trash Removal, Gated Entrance and Security
<b>Building Restrictions:</b>	House Size Minimum 3,500 SF GLA
<b>Covenants:</b>	Restrictions—Yes
<b>Amenities:</b>	Clubhouse, Common Area, Pool, Health Club, Golf Course—additional Fees may apply

## *Assessor Map*

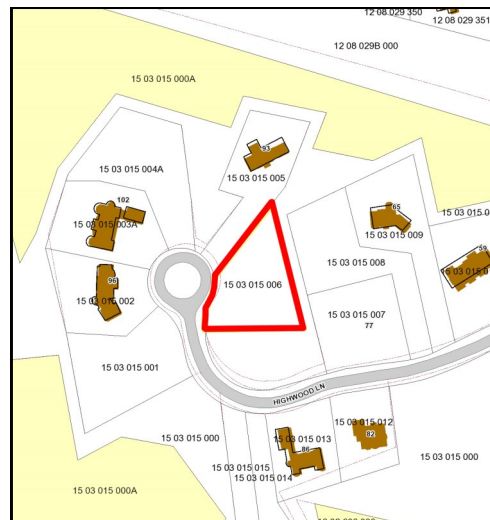



## Lot 6 Defined



The Golf Club of  
Cape Cod Clubhouse

## Satellite Map





*Photographs*





*Photographs*

