



# HARTEL COMMERCIAL REAL ESTATE

*Strategic Real Estate Services*

**342 Gifford Street - Units 4A & 4B - "Homeport" - Falmouth, MA**

**Investment Opportunity**  
**FULLY LEASED**



- \* **1,500± SF TOTAL OFFICE SPACE AVAILABLE - 2 UNITS AT 700± SF & 800± SF**
  - \* **CLOSE TO FALMOUTH HOSPITAL & MEDICAL COMMUNITY**
    - \* **LOCATED LESS THAN 1/4 MILE TO RTE 28**
    - \* **WELL ESTABLISHED OFFICE PARK - ZONED B3**
    - \* **YEAR ROUND ACTIVITY**

**Offered For Sale at \$149,900**



**HARTEL COMMERCIAL REAL ESTATE**

230 Jones Road  
Suite 6  
Falmouth MA 02540

40 Willard Street  
Suite 207  
Quincy MA 02169

Greg Hartel  
617-256-3169  
Greg@HartelRealty.com

Jody Shaw  
508-566-3556  
Jody@HartelRealty.com

Main Office  
508-444-0172  
www.HartelRealty.com



## Floorplans

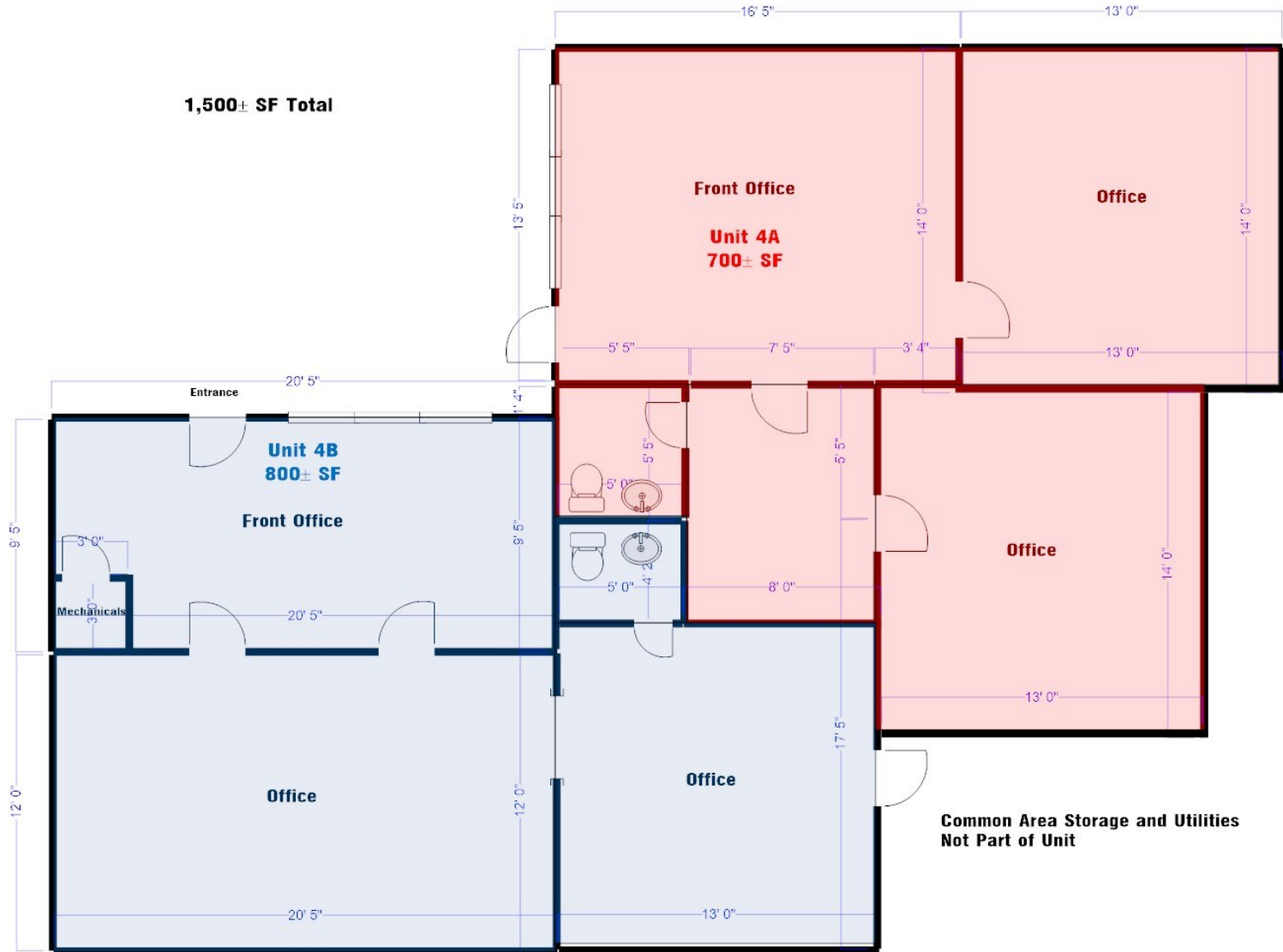





# HARTEL COMMERCIAL REAL ESTATE

*Strategic Real Estate Services*



## Satellite View



HARTEL COMMERCIAL REAL ESTATE

230 Jones Road  
Suite 6  
Falmouth MA 02540

40 Willard Street  
Suite 207  
Quincy MA 02169

Greg Hartel  
617-256-3169  
Greg@HartelRealty.com

Jody Shaw  
508-566-3556  
Jody@HartelRealty.com

Main Office  
508-444-0172  
www.HartelRealty.com





# HARTEL COMMERCIAL REAL ESTATE

Strategic Real Estate Services



## Neighborhood View



HARTEL COMMERCIAL REAL ESTATE

230 Jones Road  
Suite 6  
Falmouth MA 02540

40 Willard Street  
Suite 207  
Quincy MA 02169

Greg Hartel  
617-256-3169  
Greg@HartelRealty.com

Jody Shaw  
508-566-3556  
Jody@HartelRealty.com

Main Office  
508-444-0172  
www.HartelRealty.com



# Assessor Map

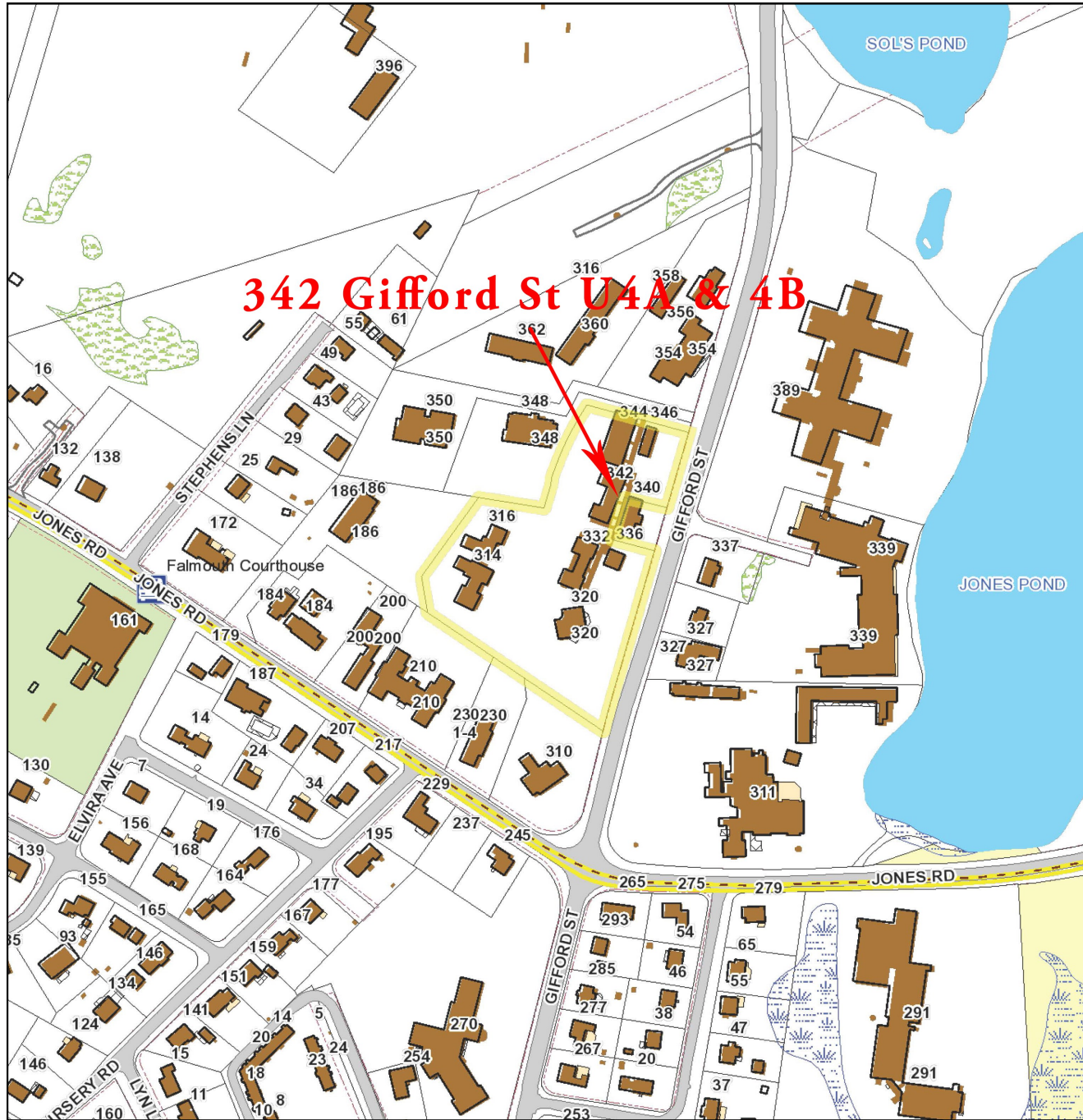



# HARTEL COMMERCIAL REAL ESTATE

*Strategic Real Estate Services*

## *342 Gifford Street Units 4A & 4B - Falmouth*

**T**his location is located just off Jones Road and Gifford Street and less than 1/4 Mile to Route 28. The Condo has two units, each having 700± SF & 800± SF FULLY LEASED. Offered For Sale at \$149,900. There is a small courtyard upon entry to each unit. There is plenty of parking on site. This area has a multitude of businesses which are complimentary to each other.

