



# HARTEL COMMERCIAL REAL ESTATE

*Strategic Real Estate Services*

---

**764 Plain Street - Marshfield, MA**

**Leasing Opportunity - New All-Inclusive Office Suites & Units  
Less Than 1 Mile from Route 3 - Stair Access**



\* ONE FIRST FLOOR UNIT AVAILABLE

\* \$2,350/MO GROSS - 1,228± SF UNIT 1-3

---

**New Office Suite - Only 1 Remaining**

---



HARTEL COMMERCIAL REAL ESTATE

230 Jones Road  
Suite 6  
Falmouth MA 02540

40 Willard Street  
Suite 207  
Quincy MA 02169

Greg Hartel  
617-256-3169  
Greg@HartelRealty.com

Main Office  
508-444-0172  
www.HartelRealty.com



## Property Detail - Rear Office Building

---

- **First Floor Unit - Rear Building - Unit 1-3**
  - **Leasable Space Available - 1,228± SF**
  - **\$2,350/Month/Plus Utilities - Available Now**
- 

The town of Marshfield is located 27 miles from Boston's business district in the southeastern section of Massachusetts. There is direct access to Route 3 at exit 12, less than one mile north.

Co-located with Starbucks, 7-11, Lapels, Anthony's Pizza & more.

This location is in a high traffic area less than one mile from Exit 12 on Route 3. Area businesses include restaurants, office buildings, coffee shops, super markets and shopping plazas.





# HARTEL COMMERCIAL REAL ESTATE

*Strategic Real Estate Services*



## Satellite View



HARTEL COMMERCIAL REAL ESTATE

230 Jones Road  
Suite 6  
Falmouth MA 02540

40 Willard Street  
Suite 207  
Quincy MA 02169

Greg Hartel  
617-256-3169  
Greg@HartelRealty.com

Main Office  
508-444-0172  
www.HartelRealty.com

# Assessor Map

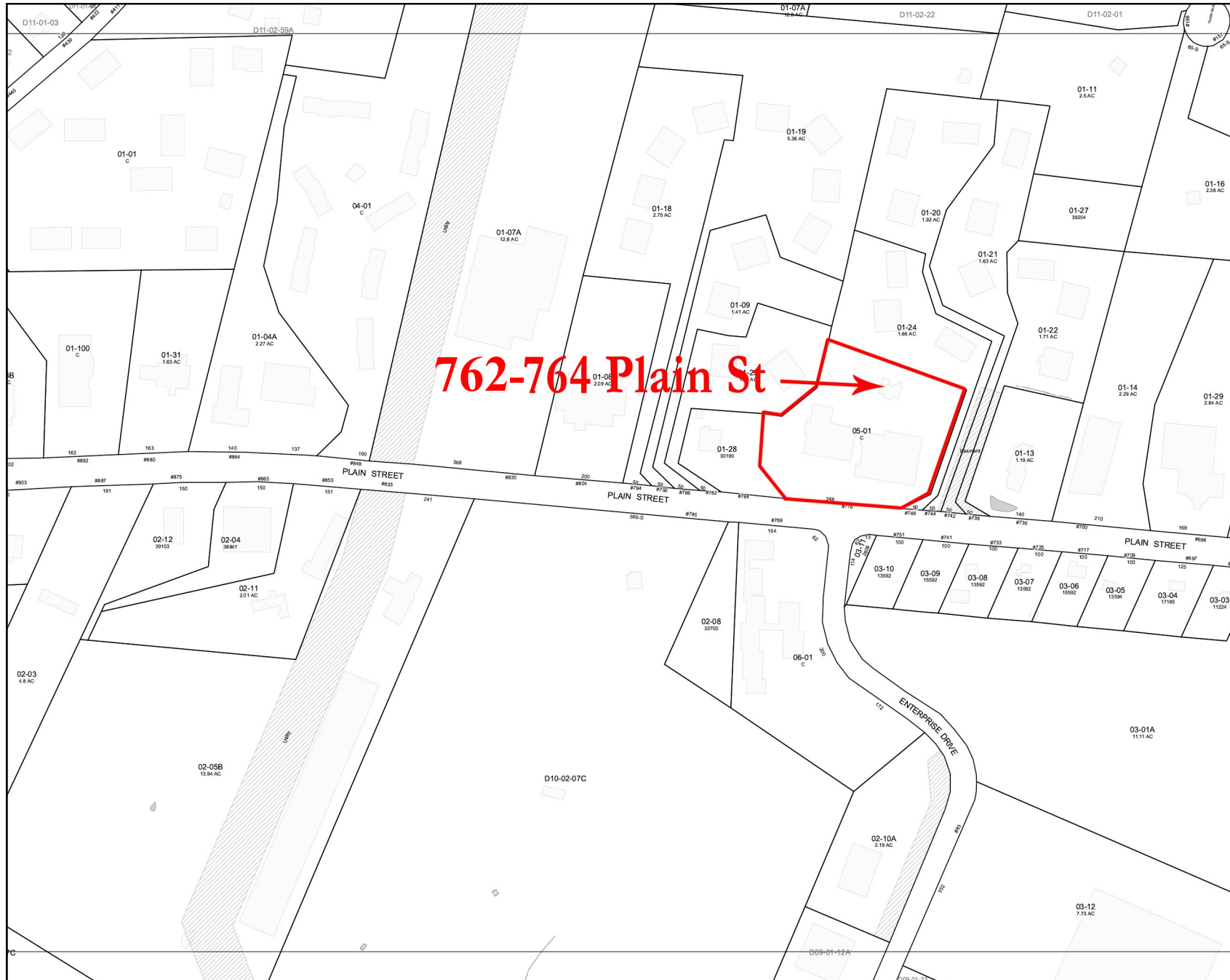

# Zoning Map

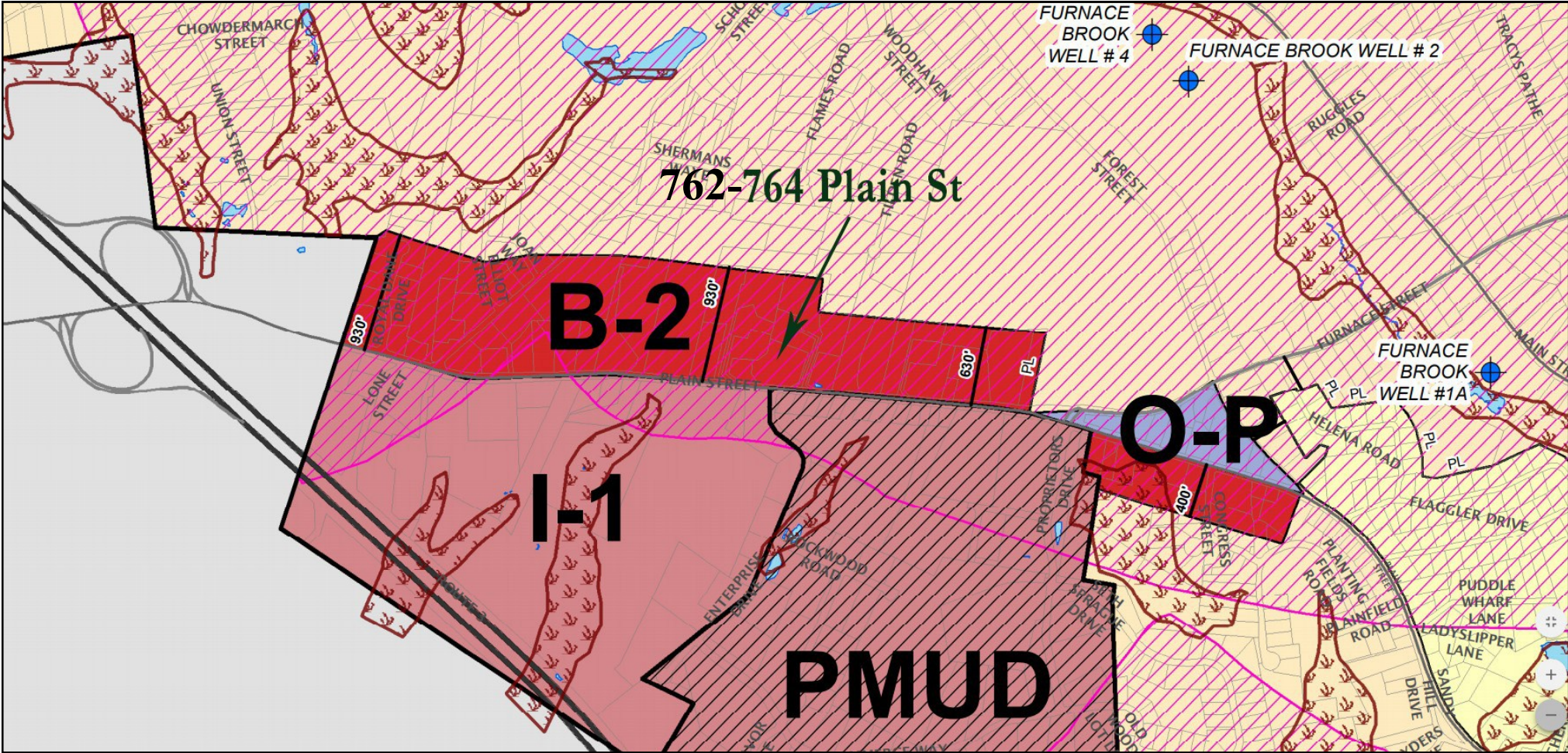

*Photographs - First Floor Office*



*Photographs - First Floor Office*

