



FOR LEASE

**FENCED/PAVED GROUND STORAGE
COVERED CONTRACTOR BAYS - UNDER SOLAR**

31,659± SF Bay For Lease at \$6,900/Mo

30,760± SF Bay For Lease at \$6,500/Mo



HARTEL COMMERCIAL REAL ESTATE

FALMOUTH

118 ECHO ROAD

MASHPEE, MA

118 Echo Rd - Mashpee, MA

PROPERTY DETAILS

**Fenced In - Covered Contractor Bays - Under Solar
Utilities and Fencing Built to Suit for Tenant Needs
Ground Storage For Lease**

- * LOCATED OFF ROUTE 130
- * 2.83± MILES TO ROUTE 28
- * 4.26± ACRE SITE
- * 2 INDIVIDUAL CONTRACTOR BAYS
- * FENCED & PAVED
- * 1 CONTRACTOR BAY AT 31,659± SF
- * 1 CONTRACTOR BAY AT 30,760±/SF
- * WASH AREA FOR TRUCKS
- * ONSITE BATHROOM

2 Contractor Bays Available

Fenced and Paved

**31,659± SF Bay For Lease at \$6,900/Mo
30,760± SF Bay For Lease at \$6,500/Mo**

Estimated Completion:

November 2025



HARTEL COMMERCIAL REAL ESTATE
FALMOUTH

230 Jones Road
Suite 6
Falmouth MA 02540

Greg Hartel
617-256-3169
Greg@HartelRealty.com

Jody Shaw
508-566-3556
Jody@HartelRealty.com

Main Office
508-444-0172
www.HartelRealty.com

118 Echo Rd - Mashpee, MA



118 Echo Rd - Mashpee, MA



118 Echo Rd - Mashpee, MA



118 Echo Rd - Mashpee, MA



118 Echo Rd - Mashpee, MA



118 Echo Rd - Mashpee, MA



Satellite View

118 Echo Rd - Mashpee, MA

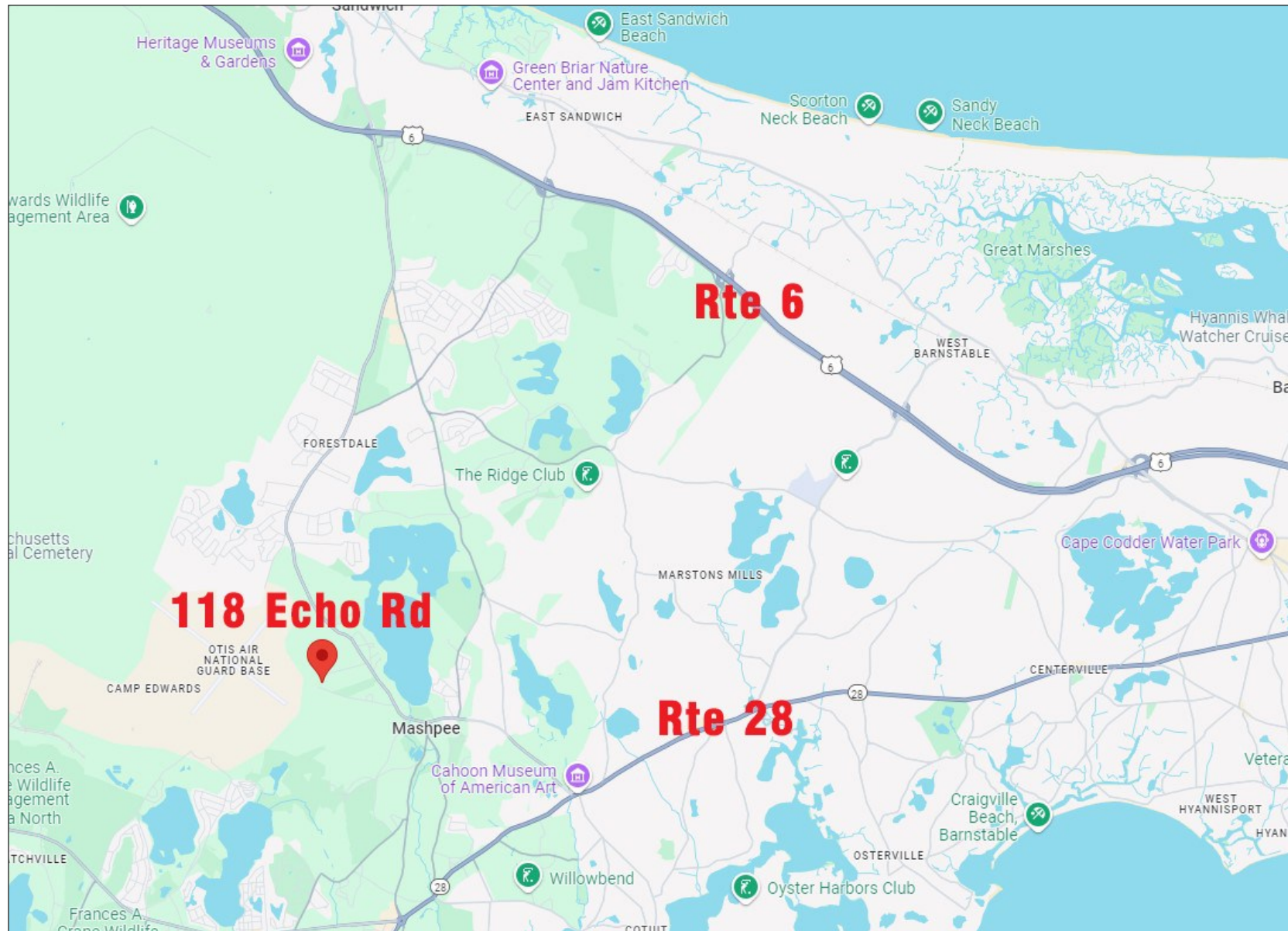

4.26± Acre Site - Easy Access to Rtes 6 & 28

118 Echo Rd - Mashpee, MA

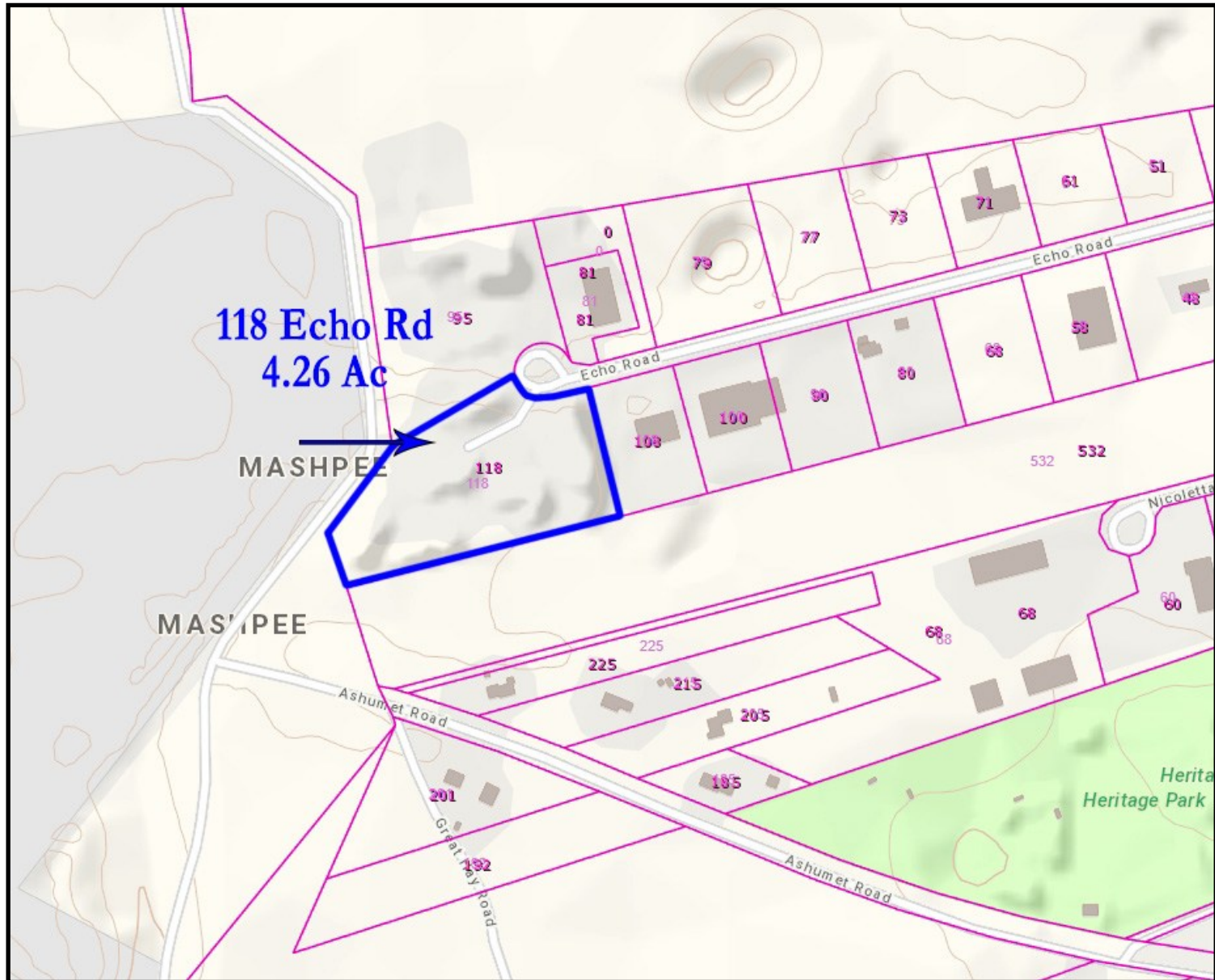

Assessor Map

118 Echo Rd - Mashpee, MA



Zoning Map

118 Echo Rd - Mashpee, MA

HARTEL COMMERCIAL REAL ESTATE

FALMOUTH, MA

230 Jones Road
Suite 6
Falmouth MA 02540

Greg Hartel
617-256-3169
Greg@HartelRealty.com

Jody Shaw
508-566-3556
Jody@HartelRealty.com

Main Office
508-444-0172
www.HartelRealty.com

CONTACTS

***DISCLAIMER:** ALL INFORMATION CONTAINED HEREIN WAS RESEARCHED AND OBTAINED BY SOURCES DEEMED TO BE RELIABLE. WE MAKE NO REPRESENTATION OR WARRANTIES OF ANY KIND DUE TO THE ACCURACY CONTAINED WITHIN THIS LISTING. PLEASE CONDUCT YOUR OWN RESEARCH OF THE PROPERTY TO VERIFY ANY AND ALL INFORMATION. WE ARE NOT RESPONSIBLE FOR ANY INFORMATION WHICH IS RELIED UPON WITHOUT FURTHER DUE DILIGENCE AND INVESTIGATION.