



FOR LEASE

**FENCED/PAVED GROUND STORAGE
COVERED CONTRACTOR BAYS - UNDER SOLAR**

31,659± SF Bay For Lease at \$6,900/Mo

30,760± SF Bay For Lease at \$6,500/Mo



HARTEL COMMERCIAL REAL ESTATE

FALMOUTH - QUINCY

118 ECHO ROAD

MASHPEE, MA



**Fenced In - Covered Contractor Bays - Under Solar
Utilities and Fencing Built to Suit for Tenant Needs
Ground Storage For Lease**

- * LOCATED OFF ROUTE 130
- * 2.83± MILES TO ROUTE 28
- * SITUATED ON 4.26± ACRES
- * 2 INDIVIDUAL CONTRACTOR BAYS
- * FENCED & PAVED
- * 1 CONTRACTOR BAY AT 31,659± SF
- * 1 CONTRACTOR BAY AT 30,760±/SF
- * WASH AREA FOR TRUCKS
- * ONSITE BATHROOM

2 Contractor Bays Available

Fenced and Paved

31,659± SF Bay For Lease at \$6,900/Mo
30,760± SF Bay For Lease at \$6,500/Mo

Estimated Completion:

November 2025



HARTEL COMMERCIAL REAL ESTATE

FALMOUTH - QUINCY

118 ECHO ROAD

MASHPEE, MA





HARTEL COMMERCIAL REAL ESTATE

FALMOUTH - QUINCY

118 ECHO ROAD

MASHPEE, MA



118 Echo Rd - Mashpee, MA

Satellite View



118 Echo Rd - Mashpee, MA

4.26± Acre Site - Easy Access to Rtes 6 & 28

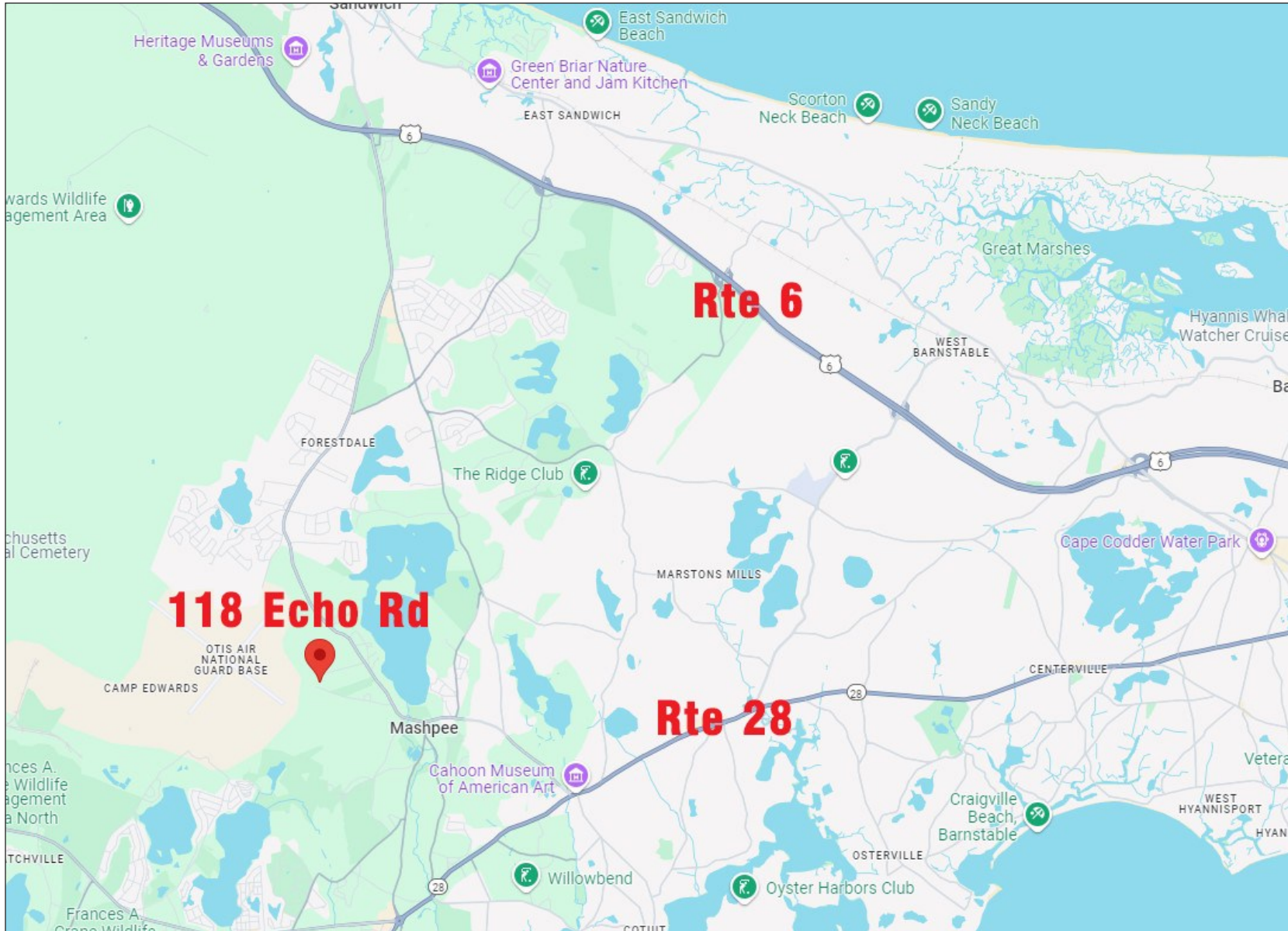



HARTEL COMMERCIAL REAL ESTATE

Strategic Real Estate Services

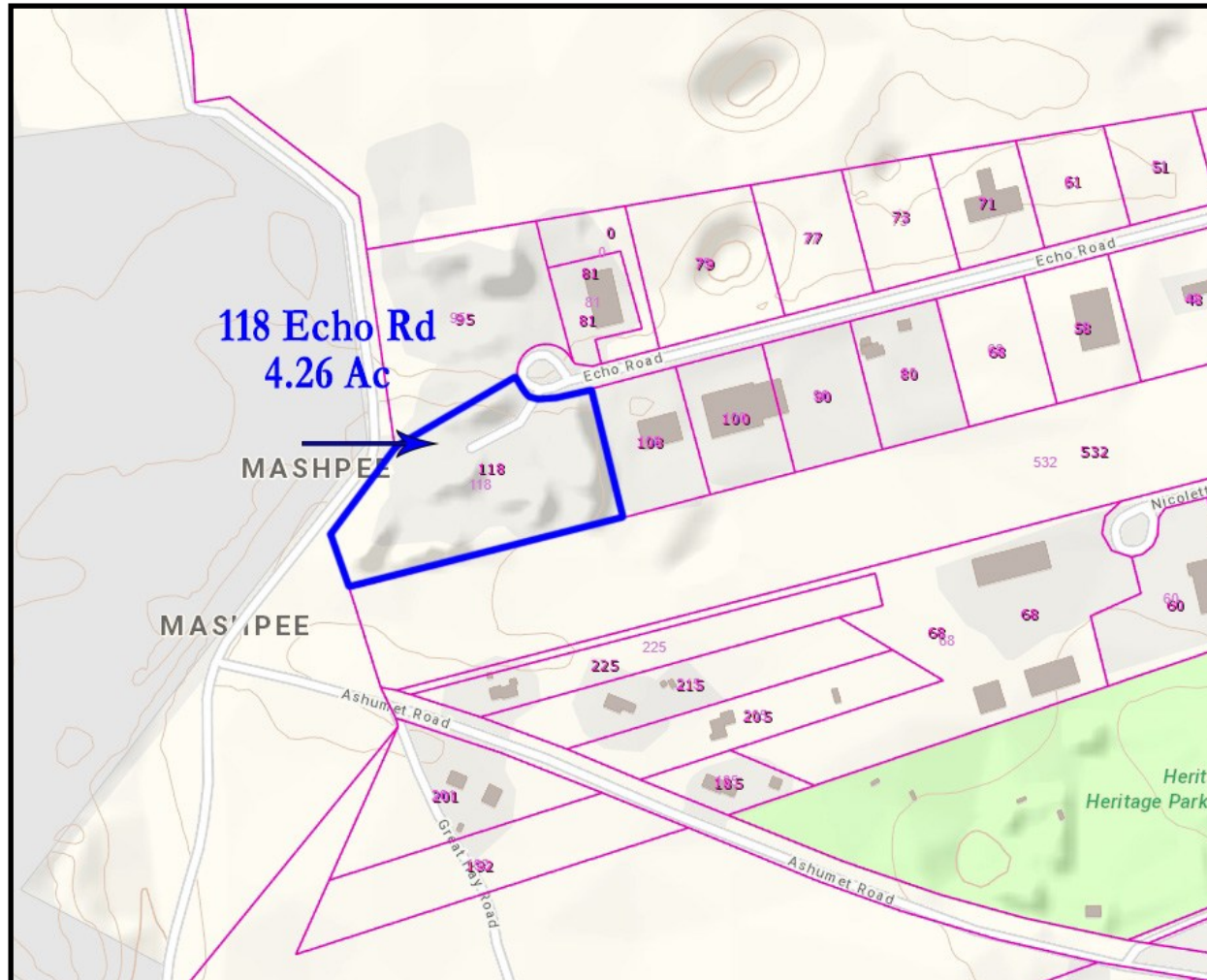

Assessor Map



HARTEL COMMERCIAL REAL ES-

230 Jones Road
Suite 6
Falmouth MA 02540

40 Willard Street
Suite 207
Quincy MA 02169

Greg Hartel
617-256-3169
Greg@HartelRealty.com

Jody Shaw
508-566-3556
Jody@HartelRealty.com

Main Office
508-444-0172
www.HartelRealty.com



HARTEL COMMERCIAL REAL ESTATE

Strategic Real Estate Services



Zoning Map



HARTEL COMMERCIAL REAL ESTATE

230 Jones Road
Suite 6
Falmouth MA 02540

40 Willard Street
Suite 207
Quincy MA 02169

Greg Hartel
617-256-3169
Greg@HartelRealty.com

Jody Shaw
508-566-3556
Jody@HartelRealty.com

Main Office
508-444-0172
www.HartelRealty.com